

Round flow cassette

360° air discharge for improved comfort

- > Industry-first and proven design.
- > Wider flaps to even further improve equal temperature distribution

More energy efficient and user-friendly than any other cassette

- > Running costs can be reduced down to 50% compared with standard solutions
- > Automatic filter cleaning.
- > Less time is required to maintain the filter: dust can be removed easily with a vacuum cleaner without opening the unit.

Intelligent sensors improve efficiency and comfort even more

- > The presence sensor adjusts the set point if no one is detected in the room leading to up to 27% savings.
- > It also automatically directs air flow away from any person to avoid draught.
- > The infrared floor sensor detects the average floor temperature and ensures even temperature distribution between ceiling and floor to prevent cold feet.

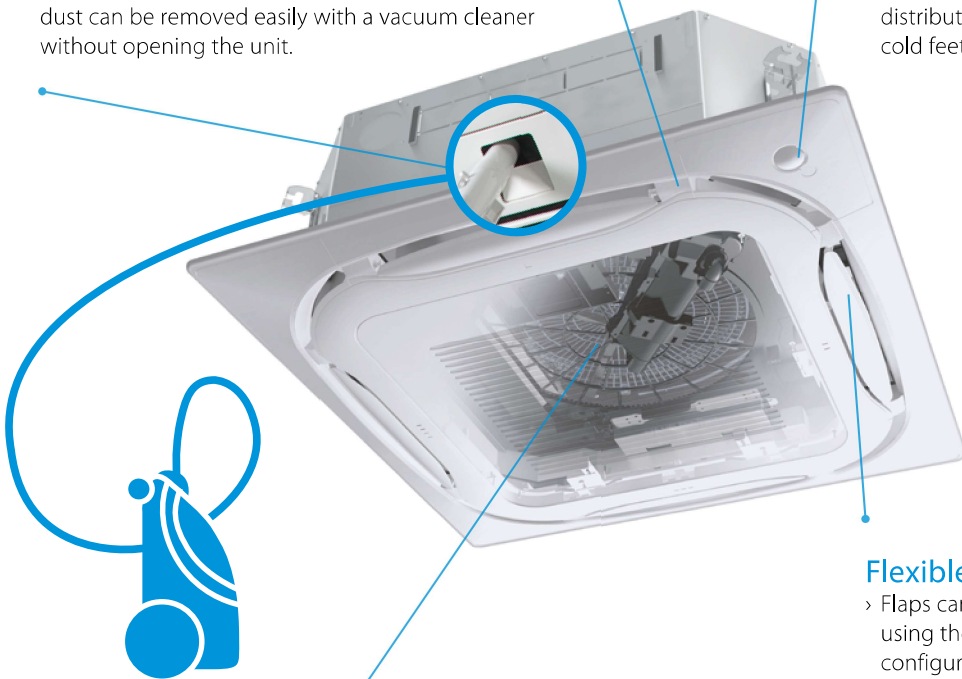
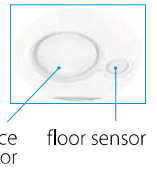

Flexible installation

- > Flaps can be individually controlled or closed using the wired remote control, to suit room configuration. Optional closure kits are also available.

Auto cleaning filter

Dust can simply be removed using a vacuum cleaner without opening the unit.

* Available as an option

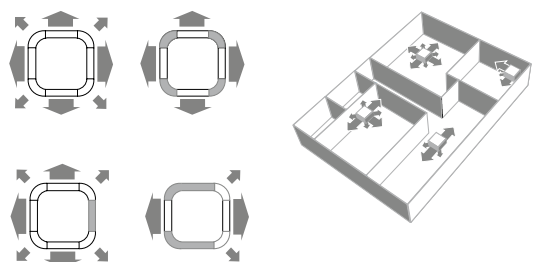

Widest ever range of decoration panels to fit the interior and application

Standard panels available in white and black

› The unique Daikin round flow cassette with 360° air flow, wide flaps and optional intelligent sensors



BYCQ140E
White standard panel



BYCQ140EW
Full white standard panel



BYCQ140EB
Black standard panel

Auto cleaning panels available in white and black

› The unique Daikin auto cleaning cassette with wide flaps and optional intelligent sensors



BYCQ140EGF
White auto cleaning panel



BYCQ140EGFB
Black auto cleaning panel

Designer panel in white and black

› New line of design panels hiding air intake grilles for a more stylized outlook
› With 360° air flow, wide flaps and optional intelligent sensors



BYCQ140EP
White designer panel



BYCQ140EPB
Black designer panel



ROUND FLOW CASSETTE, BLACK DESIGNER PANEL



ROUND FLOW CASSETTE AUTO
CLEANING PANEL WITH FINE MESH FILTER



Round flow cassette

360° air discharge for optimum efficiency and comfort

- > Combination with split outdoor units is ideal for small retail, offices or residential applications
- > Optional automatic filter cleaning panel results in higher efficiency & comfort and lower maintenance costs. 2 filters available: standard filter and finer mesh filter
- > Two optional intelligent sensors improve energy efficiency and comfort
- > Widest choice ever in decoration panels: designer panels in white (RAL9010) and black (RAL9005) and standard panels in white (RAL9010) with grey louvers or full white
- > Bigger flaps and unique swing pattern improve equal air distribution
- > Individual flap control: flexibility to suit every room layout without changing the location of the unit!
- > Optional fresh air intake
- > Branch duct discharge allows to optimize air distribution in irregular shaped rooms or to supply air to small adjacent rooms
- > Standard drain pump with 675mm lift increases flexibility and installation speed



More details and final information can be found by scanning or clicking the QR codes.



FCAG-B



RXM-R



RXM-R9

Efficiency data		FCAG + RXM		35B + 35R9		50B + 50R		60B + 60R		
Cooling capacity	Nom.	kW		3.50		5.00		5.70		
Heating capacity	Nom.	kW		4.20		6.00		7.00		
Space cooling	Energy efficiency class				A++		A++			
	Capacity	Pdesign	kW		3.50		5.00		5.70	
	SEER			6.35		6.54		6.40		
	ηs,c			-						
	Annual energy consumption	kWh/a		193		268		312		
Space heating (Average climate)	Energy efficiency class				A++		A+			
	Capacity	Pdesign	kW		3.32		4.36		4.71	
	SCOP/A			4.90		4.30		4.20		
	ηs,h			-						
	Annual energy consumption	kWh/a		948		1,418		1,569		
Indoor unit		FCAG		50B		60B		35B		
Dimensions	Unit	HeightxWidthxDpeth		mm		204x840x840				
Weight	Unit			kg		19		18		
Air filter	Type					Resin net				
Decoration panel	Model					Standard panels: BYCQ140E - white with grey louvers / BYCQ140EW - full white / BYCQ140EB - black Auto cleaning panels: BYCQ140EGF - white / BYCQ140EGFB - black Designer panels: BYCQ140EP - white / BYCQ140EPB - black				
		Dimensions	HeightxWidthxDpeth	mm		Standard panels: 65x950x950 / Auto cleaning panels: 148x950x950 / Designer panels: 106x950x950				
Fan	Weight			kg		Standard panels: 5.5 / Auto cleaning panels: 10.3 / Designer panels: 6.5				
		Air flow rate	Cooling	Low/Medium/High	m³/min		9.4/11.8/14.6		9.6/12.2/14.9	
Sound power level	Heating			m³/min		9.4/11.8/14.6		9.6/12.2/14.9		
		Cooling			dBA		49.0		51.0	
Sound pressure level	Heating			dBA		49.0		51.0		
		Cooling	Low/Medium/High	dBA		27.0/29.0/31.0		28.0/31.0/33.0		
Control systems	Wired remote control			dBA		27.0/29.0/31.0		27.0/29.0/31.0		
		Infrared remote control					BRC7FA532F / BRC7FB532F / BRC7FA532FB / BRC7FB532FB BRC1H52W/S/K / BRC1E53A / BRC1E53B / BRC1E53C / BRC1D52			
Power supply	Phase/Frequency/Voltage			Hz/V		1~/50/60/220-240/220				
		Outdoor unit								
Dimensions	Unit	HeightxWidthxDpeth		mm		734x870x373		552x840x350		
Weight	Unit			kg		49.0		32		
Sound power level	Cooling			dBA		-		49.0		
Sound pressure level	Heating			dBA		48.0		49.0		
		Cooling	Nom.	dBA		49.0		49.0		
Operation range	Heating	Ambient	Min.~Max.	°CDB		-10 ~50 (4) / 46 (5)		-10 ~50 / 46		
		Ambient	Min.~Max.	°CWB		---				
Refrigerant	Type/GWP					R-32/675.0				
		Charge			kg/TCO2Eq		1.15 /0.780		0.76 /0.52	
Piping connections	Liquid/Gas OD			mm		6.35/12.7		6.35/9.50		
		Piping length	OU - IU	m		30		20		
		System	Chargeless	m		-		10		
		Additional refrigerant charge			kg/m		0.02 (for piping length exceeding 10m)			
		Level difference	IU - OU	m		20.0		15		
Power supply	Phase/Frequency/Voltage			Hz/V		1~/50 /220-240				
Current - 50Hz	Maximum fuse amps (MFA)			A		16		-		

Contains fluorinated greenhouse gases